



## PLUS 14

trafimet  
distributiontrafimet  
welding & cutting

	<b>V</b> peak	113		0,6 - 0,8 0,9 - 1,0 - 1,2	<b>X</b>	160A CO <sub>2</sub> 140A Mix
				2,5 - 3 - 4 m		60%
						0,65 Kg
						1 m



CODE	← →	↔	⚡
MA0411	3 m		EURO
MA0412	4 m		EURO
MA0416	2,5 m		Direct
MA0417	5 m		Direct

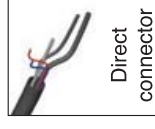

EN 60974-7



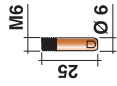
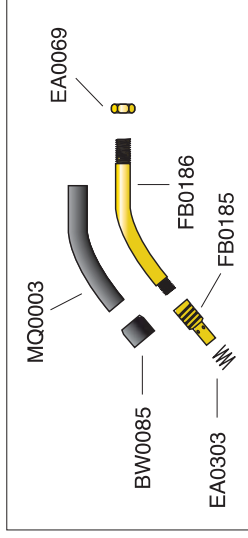

Ø mm	Ø in	Cu	Cu-Ni	Cu for Al	CuCrZr
0,6	.023	MD0008-06 (140.0008)	MD0008-36		
0,8	.030	<b>MD0008-08 (140.0059)</b>	MD0008-38	MD0008-58 (141.0002)	MD0008-78 (140.0062)
0,9	.035	MD0008-09 (140.0177)			
1,0	.040	MD0008-10 (140.0253)	MD0008-40	MD0008-60 (141.0007)	MD0008-80 (140.0256)
1,2	.045	MD0008-12 (140.0387)	MD0008-42	MD0008-62	MD0008-82

MC0017 (145.0123)	MC0018 (145.0075)	MC0266 (145.0143)	MC0019 (145.0041)	MC0020 (145.0168)
-------------------	-------------------	-------------------	-------------------	-------------------

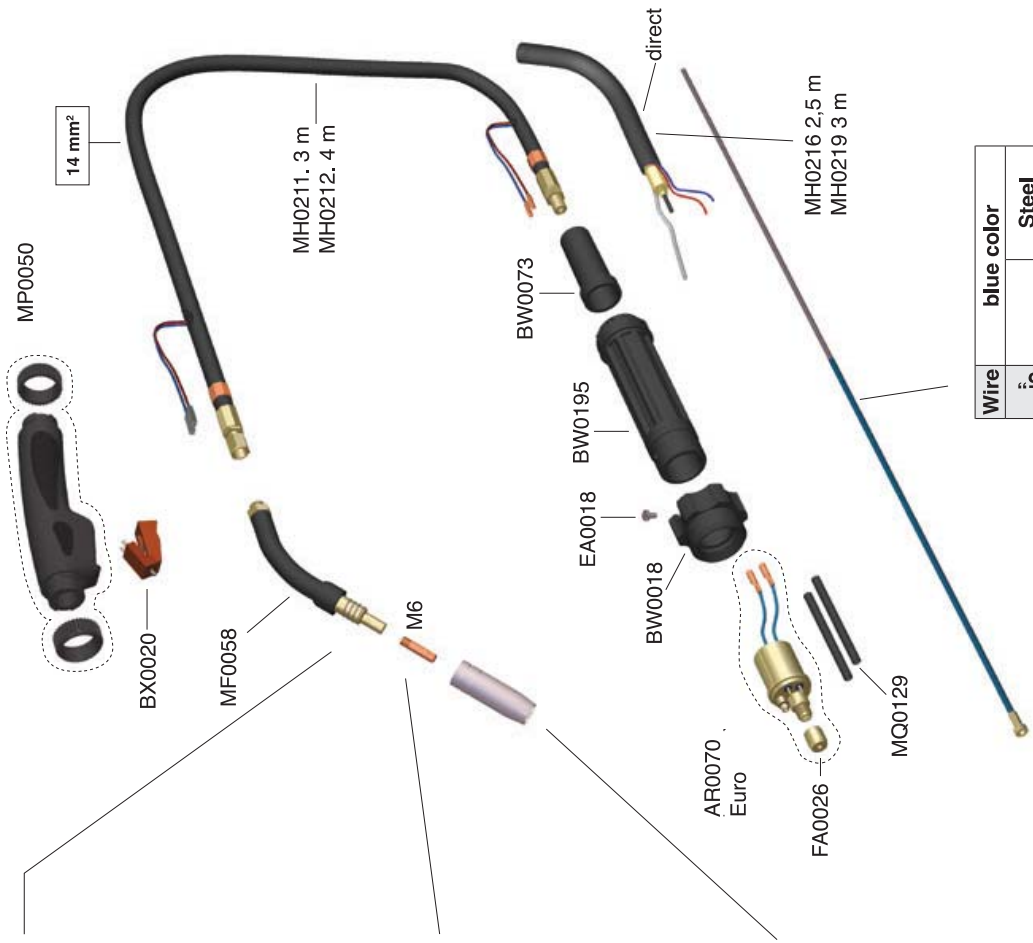
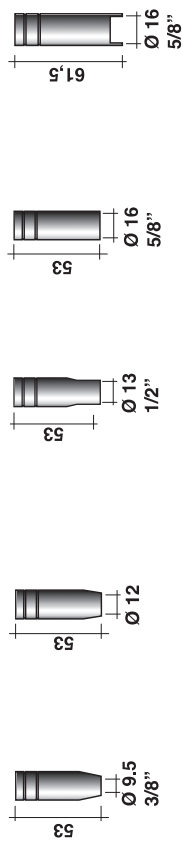

Wire	blue color	Steel
0,6	0,9	GM0500 (124.0011)
0,9	0,9	GM0501 (124.0012)
		3 m / 10'
		4 m / 12'

**STANDARD** \_\_\_\_\_ (REF.)