

Spare Parts Favorit I

231 6011-001

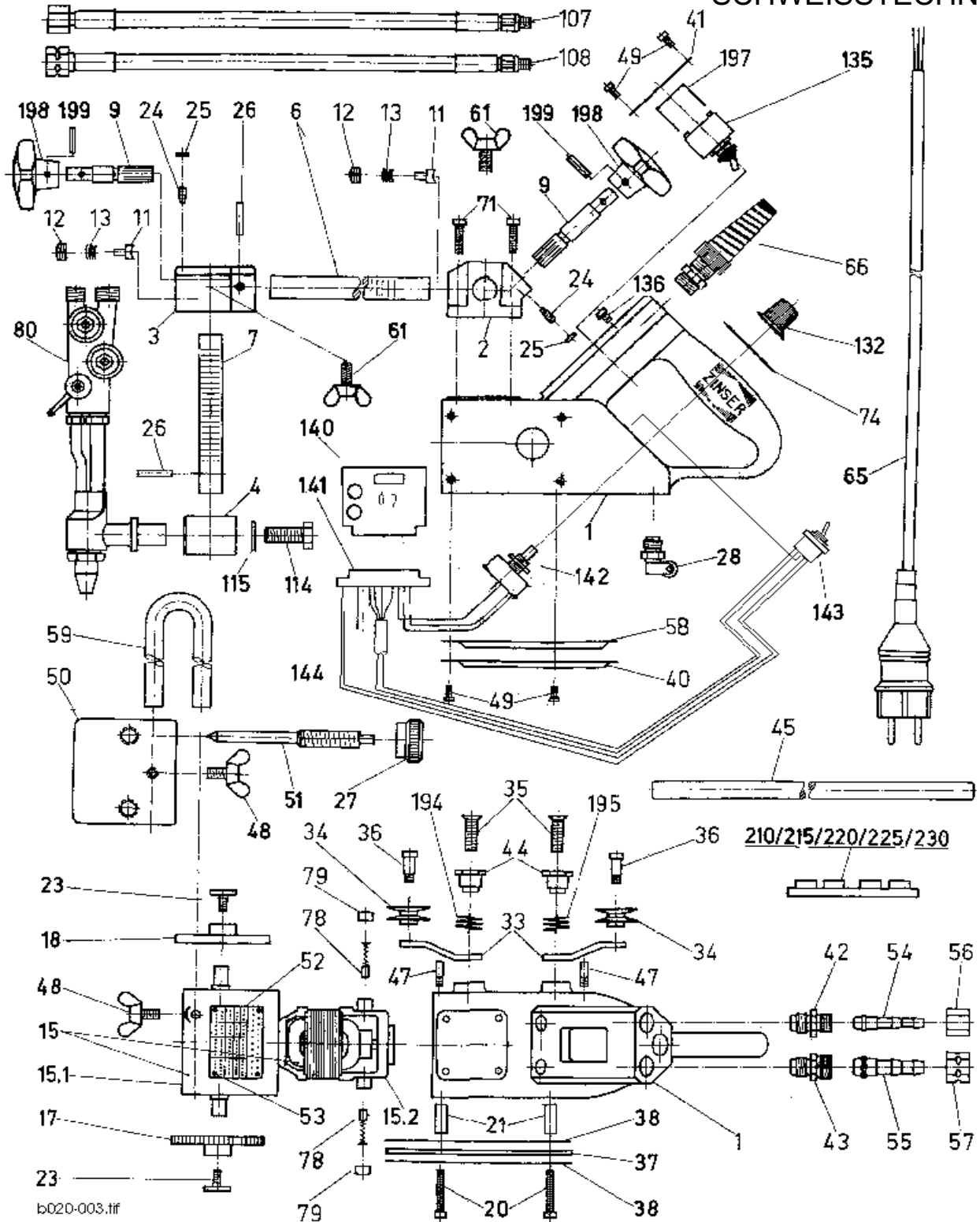

b020-003.tif

ZINER Schweisstechnik GmbH
 Daimlerstr. 4
 D-73095 Albershausen
 Phone +49 7161/5050-0
 Fax +49 7161/5050-100
 E-Mail info@ziner.de
 http://www.ziner.de

Banks:
 Kreissparkasse Göppingen
 BLZ 610 500 00
 Konto 152 582 56
 Swift-Code: GOPSDE6G
 IBAN: DE4561050000015258256

Deutsche Bank Göppingen
 BLZ 610 700 78
 Konto 030 41 05
 Swift-Code: DEUTDESS610
 IBAN: DE17610700780030410500

Managing Director:
 Ulrich Bock
Commercial Register:
 HRB Ulm 533273
 St.-Nr.: 63087/21122
 UST-Nr.: DE813055989

Number	Order Number	Description
1	235 6011-001	Housing
2	235 6012-002	Horizontal guide
3	235 6011-003	Vertical guide
4	235 6010-004	Torch holder
6	235 6010-020	Toothed rack - horizontal
7	235 6010-021	Toothed rack - vertical
9	235 6500-072	Setting pinion
11	235 6010-011	Brake plug
12	235 6010-012	Brake screw
13	050 3203-005	Plate spring 10x4.2x0.4x0.7
15	234 6500-002	Motor with gear box (complete)
15,1	235 6010-076	Gear box
15,2	235 6500-052	Motor
17	235 6010-015	Drive gear
18	235 6010-016	Roller
20	050 1001-017	Cylinder head screw M 4x30
21	235 6010-033	Distance bush
23	050 0702-055	Flat headed screw M 5x8
24	050 1401-001	Set screw M 4x12
25	050 1901-006	Hexagon nut M 4
26	050 4101-019	Clamping sleeve 4x28
27	235 6010-083	Adjusting knob
28	233 6010-011	Guide roll complete
33	235 6010-026	Swivel arm
34	235 6010-027	Roll
35	050 0901-036	Counter sunk screw M 8x25
36	235 6010-028	Bolt
37	235 6012-034	Thermal protection (Isoplan)
38	235 6012-035	Thermal protection shield
40	235 6010-036	Cover plate
41	235 5250-108	Type plate
42	060 0402-008	Junction nipple (oxygen)
43	060 0402-013	Junction nipple (gas)
44	235 6010-029	Guide roll complete
45	235 6010-085	Compass bar
47	235 6010-041	Stud bolt
48	050 1501-006	Wing screw M 6x6
49	050 1202-050	Chesse head thread cutting screw BM 3x8
50	235 6010-081	Addition weight
51	235 6010-082	Compass peak
52	235 6010-032	Shield
53	050 4201-002	Round head grooved pin 1.4x4
54	060 0400-003	Hose clip (Cutting oxygen) B 6xR 1/4
55	060 0400-002	Hose clip (Gas) B 9xR 3/8
56	060 0401-003	Cap nut C R 1/4
57	060 0401-020	Cap nut C R 3/8
58	235 6010-037	Insulating plate
59	235 6010-084	Relay
61	050 1501-006	Wing screw M 6x16
65	285 0065-032	Flex with connector (5m)
66	029 0008-003	Screwed gable gland
71	050 1002-008	Cylinder head screw M 5x16
74	235 6010-070	Scale
78	285 0182-001	Carbon brush with spring
79	284 0183-002	Bracket for carbon brush
80	231 4010-001	Cutting torch complete
107	234 6010-001	Armoured tube (Cutting oxygen) complete
108	234 6010-002	Armoured tube (Gas) complete
114	050 0110-052	Hexagon bolt M 10x25
115	050 3501-007	Washer 10.5
132	285 0007-006	Adjusting knob
135	235 7110-020	Toggle switch
136	050 0701-005	Earth screw M 4x6
140	235 6010-200	Feed control
141	235 6010-101	Edge connector
142	235 6010-102	Potentiometer
143	235 6010-058	Change over switch forward/backward
144	234 6010-005	Electrical parts complete (141/142/143)
194	235 6010-030	Torsion spring left
195	235 6010-031	Torsion spring right
197	235 6010-073	Insulation part
198	040 1401-003	Handwheel C 50
199	050 4101-010	Clamping sleeve 3x18
210	235 6010-113	Guide rail 1.0m
215	235 6010-114	Guide rail 1.5m
220	235 6010-115	Guide rail 2.0m
225	235 6010-116	Guide rail 2.5m
230	235 6010-117	Guide rail 3.0m